

**ROOF PLAN (BLOCK-1)**  
SCALE: 1:100

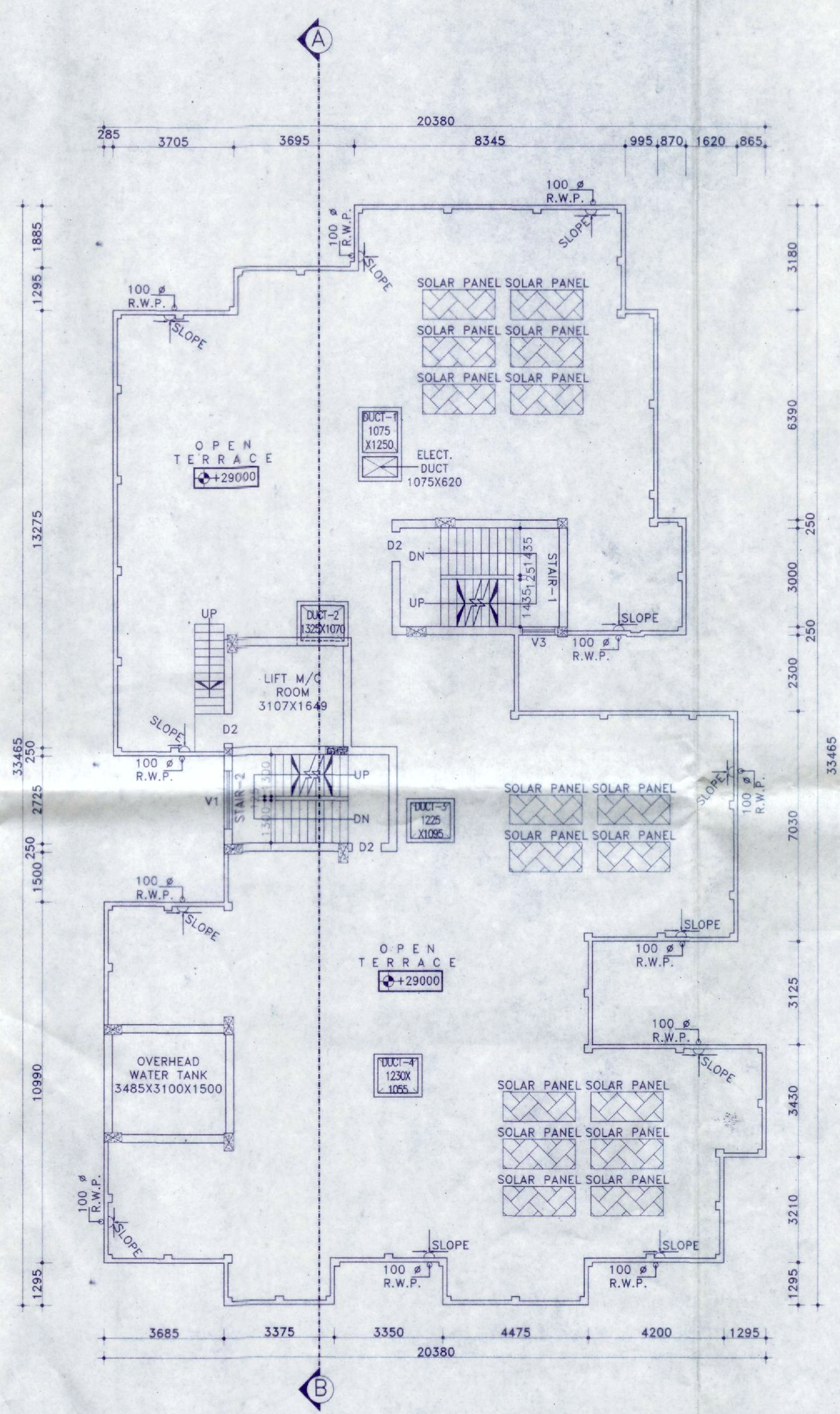

**ROOF PLAN (BLOCK-2)**  
SCALE: 1:100

**SCHEDULE OF DOOR & WINDOW:-**

MARK	SIZE	DESCRIPTION
D1	1000X2100	FULLY PNL
D2	900X2100	FULLY PNL
D3	750X2100	FULLY PNL
W	1800X1200	SLIDING WINDOW
W1	1500X1200	SLIDING WINDOW
W2	1000X1200	SLIDING WINDOW
W3	1250X1200	SLIDING WINDOW
V	600X450	UPVC MOVABLE VENTILATOR
V1		VENTILATION FOR STAIR CASE.

**PROJECT NAME:-**  
PLAN OF PROPOSED (G+9) TEN STORIED RESIDENTIAL BUILDING OF(BLOCK-01&BLOCK-02)  
1) SRI. UJJWAL GHOSH,S/O-LATE SADHU CHARAN GHOSH,2)SRI. UTTAM KUMAR GHOSH S/O LATE SADHU CHARAN GHOSH,3)SRI. ANUP GHOSH S/O LATE SADHU CHARAN GHOSH,4)SMT. MALATI LAHA W/O SRI SUNIL LAHA,5)SMT. RINA GHOSH W/O SRI. MUKTI PADA GHOSH,6)MR. KRIPAMOY MONDAL S/O LATE SRISTI DHAR MONDAL,7)MR. SUBODH GHOSH S/O LATE SAMBHUNATH GHOSH,8)MR. SANJIB KUMAR GHOSH S/O LATE SAMBHUNATH GHOSH,9)SMT. DIPHA GHOSH DASTIDAR W/O MR. PARNESH GHOSH DASTIDAR.(DEVELOPED BY ASSUS REALCON & DEVELOPERS) AT J.L NO-109, R.S. PLOT NO- 21,22,23, L.R. PLOT NO. - 39,53,54,55 KHATIAN NO-1666,2486,2680,2681,2682,2301,2298,2299, 2300, MOUZA-SHANKARPUR ,P.S.- NEW TOWNSHIP.

- NOTES :-**
- ALL DIMENSIONS ARE IN M.M. AND ALL LEVEL ARE IN M.
  - WRITTEN DIMENSIONS MUST BE FOLLOWED
  - ALL EXTERNAL WALLS 250TH. & INTERNAL WALLS 125THK. UNLESS OTHERWISE MENTIONED.
  - ALL MASONRY WORKS ARE BOUNDED BY CEMENT MORTAR (1:6) & (1:4).
  - EXTERNAL PLASTER IS 25THK. & INTERNAL PLASTER IS 12MM.THK.
  - ALL CONC. GRADE IS M25 & AND GRADE OF STEEL FE-500
  - 250THK. BRICK WORK IN 1:6 MORTAR
  - 125THK. & 75THK. BRICK WORK IN 1:4 MORTAR
  - 150 WIDE SURFACE DRAIN SHOULD BE PROVIDED ALL ROUND THE BUILDING.
  - 25% OF THE BUILDING TO BE CONSTRUCTED USING FLY-ASH BRICKS

**AREA CALCULATION:-**

LAND AREA (SQ.M.)	PLINTH AREA	BLOCK - 1		BLOCK - 2	
		(SQ.M.)	(SQ.M.)	(SQ.M.)	(SQ.M.)
2074.42 SQ.M (51.26 DECIMAL)	GROUND FLOOR	447.76	470.46		
	FIRST FLOOR	464.41	531.29		
	SECOND FLOOR	464.41	531.29		
	THIRD FLOOR	464.41	531.29		
	FORTH FLOOR	464.41	531.29		
	FIFTH FLOOR	464.41	531.29		
	SIXTH FLOOR	464.41	531.29		
	SEVENTH FLOOR	464.41	531.29		
	EIGHT FLOOR	464.41	531.29		
	NINTH FLOOR	464.41	531.29		
	TOTAL	4627.45	5252.11		

GROUND COVERAGE AREA = 40.75 %  
F.A.R = 2.24  
NO. OF FLATS = 90  
NO. OF CAR PARKING = 56

**TITLE:-**  
ROOF PLAN (BLOCK-1 & BLOCK-2).

SIGNATURE OF STRUCTURAL ENGINEER:- <i>H. M. Ghosh</i> HIRMA GHOSH Structural Engineer Lic. No. - LPM/162/AMC-DMC/BD/185 DCE, B-TECH, G.I.D.S., Durgapur-16 Contact No. - 9333233331	SIGNATURE OF GEO-TECHNICAL ENGINEER:- <i>Manoj Maity</i> MANOJ MAITY Civil / Geotechnical Engineer CE, MIGS - LMA278 Lic. No. - LPM/162/AMC G.I.D.S., Durgapur - 16	SIGNATURE OF ARCHITECT:- <i>H. M. Ghosh</i> HIROK GHOSH Consultant Civil Engineer - (Class-A) Lic. No. - LPM/162/AMC-DMC/BD/185 DCE, B-TECH, G.I.D.S., Durgapur-16 Contact No. - 9333233331	SIGNATURE OF DEVELOPER/OWNER:- <i>Ujjwal Ghosh, Kripamoy Mondal, Subodh Ghosh, Dipan Ghosh Dastidar, Sanjib Kumar Ghosh, Anup Ghosh, Malati Laha, Rina Ghosh</i>	CHECKED BY: H.GHOSH DATE : 26.02.2021 SCALE : 1:100. REV-00 SHEET NO:- GID/P&RD/ARCH-05/06
---	---	---	---	--

Approved Plan No. 21 on Meeting No. 05/2021 Date 05/02/2021 Valid upto 05/10/2023  
Approved Plan No. 22 on Meeting No. 05/2021 Date 05/02/2021 Valid upto 05/10/2023  
Mallika Lohar  
Pradhan  
Jemua Gram Panchaya